

Cleaning

Cleaning of the compressor

Use a clean dry cloth and mild detergents to clean the outside of the unit.

ATTENTION During cleaning, make sure the internal parts of the unit are not in contact with liquids and the power cord is disconnected.

Cleaning and disinfection of the accessories

After each use, disassemble the medicine cup into three parts and wash in warm soapy water. Rinse well, shake off excess water and allow to air dry (do not towel dry). Never immerse the long thin air tubing in water.



Do not boil or autoclave angled mouthpieces, air tubes, or masks.



It is important that the cleaning instructions are carefully followed to ensure optimal operation.

Replacement of Nebulizer Kit

The following are examples of nebulizer kits you may have received in the box, depending on the NEB300BASKETBALL Series item number/configuration you received:

RES2210 Pediatric Aerosol Mask

The pediatric aerosol mask should be replaced after a long period of inactivity, or if it is obstructed by dry medication, dust, etc. With normal use, the pediatric aerosol mask should last 1 month.

RES091 Disposable Nebulizer Kit with Clear Tubing

The disposable nebulizer T-Piece kit should be replaced after a long period of inactivity, or if it is obstructed by dry medication, dust, etc. With normal use, the disposable nebulizer T-piece kit should last 1 month.

RES093 Reusable Nebulizer Kit with Green Tubing

The reusable nebulizer T-Piece kit should be replaced after a long period of inactivity, or if it is obstructed by dry medication, dust, etc. With normal use, the reusable nebulizer T-piece kit should last 6 months.

Replacement of the filter

The filter is to be replaced after approximately 30 hours of use, or when it appears dirty. Open the filter holder to replace the filter with a new one. Use Sunset BF018 Nebulizer Filters.

Do not use the device without the filter.

Maintenance and Repair

Never open the device. There are no serviceable parts within the unit. The compressor does not require lubrication or maintenance.

Troubleshooting

| Symptom | Probable Cause | Solution |
|--|--|---|
| Noisy operation | No filter in the unit. | Put a filter in the unit. |
| Nebulizer does not run or nebulization is weak | Nebulizer power switch is off. | Turn nebulizer power switch on. |
| | Plug is loose. | Make sure the plug is firmly inserted into the electrical outlet. |
| | Operating for longer than the nebulizer is designed to operate | Make sure the device has been operating within the indicated limits: 30 minutes ON/ 30 minutes OFF. |
| | Nebulizer kit nozzle or other parts are obstructed | Clean the nebulizer kit. |
| | Air tube is bent or not connected firmly. | Remove any bends or kinks in the air tube. Make sure the ends of the air tube are fitted tightly onto the main unit and onto the nebulizer. |
| | The filter is clogged. | Replace the filter. |
| | Medicine cup is empty or overfilled. | Use the appropriate amount of medicine prescribed by your physician to the medicine container. |
| There is condensation in the air tube | The medicine cup cap or baffle is loose. | Reattach the medicine cup cap and make sure the baffle is inserted properly. See diagrams. |
| | Medication has been overfilled | Adjust the amount of medicine in the medicine container to the appropriate level, connect the air tube to the air compressor, and turn the unit on. |
| | The nebulizer kit was washed but not dried. | Open and close the nebulizer kit repeatedly until the drops disappear. |



Instruction Manual

BASKETBALL

Pediatric Compressor Nebulizer

NEB300BASKETBALL SERIES

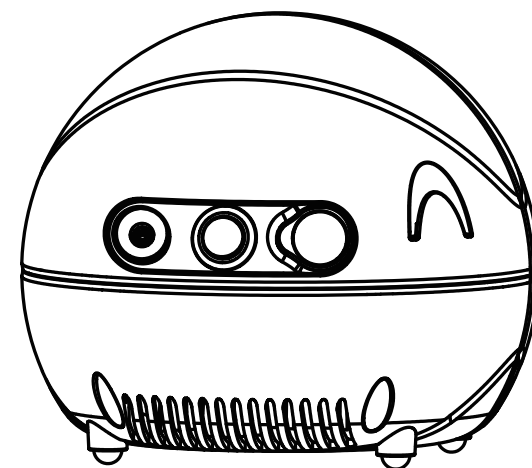

Overview

The Sunset Pediatric Basketball Compressor Nebulizer is a medical device designed to deliver medicine prescribed by a physician to the airways of the lungs. This nebulizer produces aerosol mist for inhalation by the patient for medical treatment only.

This unit is compact, simple to operate and convenient to carry. It uses a non-oil lubricating, single-cylinder piston pump to create air pressure.

The air flow created by the air compressor comes out of the jet outlet and then enters the nebulizer kit.

Important Please read the instructions carefully before operating the product.



Caution

Federal law restricts this device to sale by or on the order of a physician



Warning

Do not use near flammable objects or locations near explosive materials.

Specifications

| | |
|-----------------------------|--|
| Power | 120V AC 60 Hz |
| Power consumption | 200VA (75 W Max) |
| Compressor flow | 6 L |
| Particle size | 0.5 to 6 microns |
| MMAD | 1.663 um |
| Average mobilization rate | ≥0.15 ml/min |
| Remain amount | 0.15 mL |
| Noise level | Below 63 dBA |
| Compressor pressure range | 30 psig or greater / 206 kPa |
| Operating temperature range | 50°F to 104°F (10°C to 40°C) |
| Operation humidity | 10% to 95% RH |
| Operating pressure range | 8 ~ 13 psi / 55kPa ~ 90kPa |
| Storage temperature range | -4°F to 158°F (-10°C to 70°C) |
| Storage humidity range | 10% to 95% RH |
| Dimension (L x W x H) | 6.3 x 4.6 x 7.9 in (161 x 117 x 200mm) |
| Product weight | 3.3 lbs (1.5 kg) |

- Do not leave the unit plugged in when not in use. Unplug the device from the electrical outlet when not in operation.
- Follow the manufacturer's instructions for installing the device. The manufacturer cannot be held responsible for any damage caused by incorrect installation.
- The power supply cord cannot be replaced by the user.
- The power supply cord should always be fully unwound in order to prevent dangerous overheating.
- Before performing any cleaning operation or filter replacement, disconnect the device from the main supply by unplugging it or by turning the main power switch OFF.
- Some parts of the unit are small enough to be swallowed by children. Do not let unattended children have access to the unit.
- If you decide not to use the device, it is recommended to dispose of it according to local regulations.
- Remember to:
 - Use this device only with medications prescribed by your doctor
 - Use the accessories recommended by your doctor for therapy
- Verify that the medications prescribed by your doctor can be used with common compressor nebulizer systems for aerosol therapy.

Visual Guide

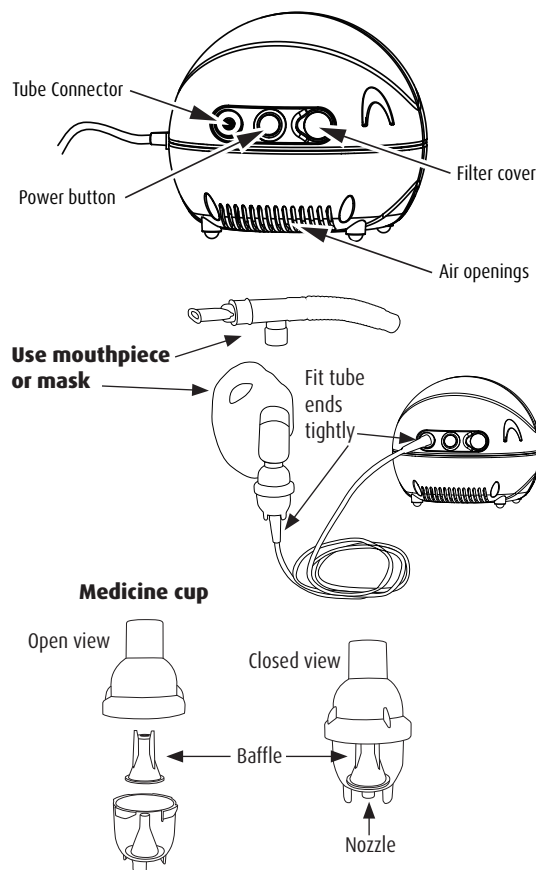

Instructions for Use



Examine the unit before the first use in order to check for possible shipping damage.

1. After unpacking the device, check the compressor and accessories for visible damage or defects such as cracks in the plastic housing, which could expose electrical components. Contact your retailer to report any damaged product.
2. Before using the device, follow the cleaning instructions as detailed in this user manual.
3. Attach the supply tube to the compressor and to the bottom of the nebulizer cup.
4. Open the nebulizer cup by pushing down on the cap and twisting counter-clockwise.
5. Add prescribed medication into nebulizer cup then turn top on until secure.
6. Attach T-piece to the nebulizer bottle. If using mask option, attach the mask in place of T-piece.
7. If using T-piece, attach mouthpiece and corrugated tube to T-piece.
8. Connect the 7ft tube to the nebulizer bottle and the nebulizer machine.
9. Ensure connections are secure before turning on the nebulizer machine.
10. Plug the compressor into the electrical outlet, making sure the electrical rating shown on the rating plate on the bottom of the unit corresponds to your main voltage.
11. To start treatment, switch the compressor on by pressing the ON/OFF switch onto the "I" position. When taking a treatment sit upright and relaxed.
12. When mist is visible, begin inhaling with the mouthpiece or mask.
13. When the treatment has been completed, switch the unit OFF by setting the switch position to "O" and disconnect the plug from the electrical outlet.
14. Wash the nebulizer and accessories as described in the cleaning section.

Warranty

Sunset Healthcare Solutions offers a limited 3-year warranty on the compressor unit to be free from defects in material and workmanship under normal use and operation for a period of 3 years from date of original retail purchase. This warranty does not extend to failures resulting from accidental damage, misuse, negligence, abuse, alteration, or improper operation. This warranty does not extend to non-durable components which are subject to normal wear and need periodic replacement nor does this warranty extend to hospital or clinic use. All items returned must be properly packaged and shipped in a manner to avoid shipping damage at the purchaser's expense.

DO NOT return any product(s) or part(s) to Sunset Healthcare Solutions without prior consent. For replacement under warranty, please call: 1-877-578-6738 (Monday to Friday, 9 am to 5 pm CST).