



Brighter  
Pediatrics by Sunset

# Policies

## Ordering Options

### Three Easy Ways To Order

#### Phone

(877) 5-SUNSET (877-578-6738)

Our customer service professionals are here to assist you M-F 8:00 AM – 5:00 PM Central Time.

#### Fax

312-997-9985 — Accepted 24 hours a day.

#### Email

sales@sunsethcs.com

*Contact us for more information on fulfillment and compliance solutions that best fit your needs.*

## Payment Methods

### Payment Portal and ACH

Visit [www.sunsethcs.com/paymentportal](http://www.sunsethcs.com/paymentportal) to pay online with ACH or credit card.

### Net 30-Day Payment Terms

For qualified companies. A 1.5% monthly finance charge will be assessed on all past due invoices.

### COD

For non-qualified companies.

### Credit Card

We accept all major credit cards. A processing fee may apply. After 10 days of invoice date, a surcharge of 2.5% will be applied.

**VISA**



**DISCOVER**

## Shipping

Ask your rep about shipping to various locations and our drop shipping partners.

### UPS

Whenever possible, orders ship via UPS. If another carrier is desired, please contact your sales rep.

All orders are packed in the smallest boxes available and combined with other products on the order to reduce shipping costs.

All products ship prepaid and are added to the invoice.

All products ship from Elgin, IL or Phoenix, AZ. Please refer to UPS.com for transit times.

### Damaged Merchandise

Call us within 10 days.

Keep original cartons for UPS inspection.

*We proudly partner with*



**VGM FULFILLMENT**



## Customer Service

### Returns

Contact us within 7 days of receiving your shipment.

All items must be unopened and in their original packaging. Call us for a return authorization number. There is no restocking charge on orders returned within 20 days of invoice. Orders returned after 20 days may be assessed a restocking fee of 15%. No returns after 90 days. (877) 5-SUNSET (877-578-6738)

### Central Distribution Center

Sunset Healthcare Solutions  
2725 Alft Ln  
Elgin, IL 60124

### Western Distribution Center

Sunset Healthcare Solutions  
6750 W Van Buren St Ste 100  
Phoenix, AZ 85043

### Problems

Please call us immediately if you have any complaints (it is helpful to ask for the customer service representative with whom you placed your order).

Or email us at: [customerservice@sunsethcs.com](mailto:customerservice@sunsethcs.com)

### Questions?

Our experienced customer service staff will be glad to provide you with information. Just give us a call.

### Pricing

All prices are in U.S. Dollars.

Taxes are added where applicable.

We make every effort to hold pricing throughout the year. However, prices are subject to change without notice.

# Content

## NIV and CPAP

### Page

---

CPAP/NIV Masks	4-5
Cough Assist Kits	6
Breathing Circuits	6-7

## Medication Delivery

### Page

---

Compressor Nebulizer	8
Mesh Nebulizer	9
Nebulizer Kit	9
Aerosol	9

## Oxygen

### Page

---

Regulators	10
Microdial Flowmeter	11
Cannula	12
Masks	12-13

## More

### Page

---

Trach Ties	14
HME	14
Tracheostomy Mask	14
Peak Flow Meter	15
Phototherapy Blanker	15
Closed Suction	16-17

## SleepNet MiniMe 2 Pediatric Nasal Mask

10/pack

### Mask with Headgear

Size	Item#	OEM#
Extra Small	<b>CM027XS</b>	60216
Small	<b>CM027S</b>	60217
Medium	<b>CM027M</b>	60218
Large	<b>CM027L</b>	60221

HCPCS#  
MASK - A7034  
HEADGEAR - A7035

- Non-vented version available

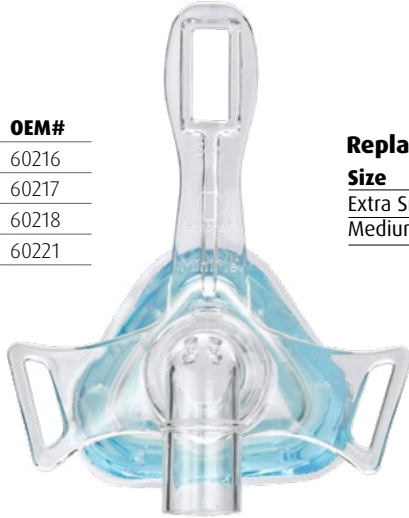

### Replacement Headgear

Size	Item#
Extra Small/Small	<b>HG027S</b>
Medium/Large	<b>HG027L</b>

Designed for children ages 2-12, Sleepnet's MiniMe2 mask features patented AIR<sup>o</sup>gel with Advanced Cushion Technology. With increased moldability, MiniMe2 provides your smallest patients with the ultimate fit and maximum comfort.

- Advanced Cushion Technology (A.C.T.)
- Custom Fit Technology
- Vented and Non-Vented Versions Available
- Touchless Spacebar™
- 360° Rotating Elbow
- Size Indicator

## Ray Pediatric CPAP/NIV Masks

Comparable to Nonny Masks

10/pack

### Mask with Headgear, Tube, and Replaceable Cushion

Size	Item#
Small	<b>CM061S</b>
Medium	<b>CM061M</b>
Large	<b>CM061L</b>
Extra Large	<b>CM061XL</b>

### Replacement Cushions

Size	Item#
Small	<b>CUCM061S</b>
Medium	<b>CUCM061M</b>
Large	<b>CUCM061L</b>
Extra Large	<b>CUCM061XL</b>

HCPCS#  
MASK - A7030  
HEADGEAR - A7035  
CUSHION - A7031



10/pack

### Nasal Mask with Headgear, Tube, and Replaceable Cushions

Comes with	Item#
S&M Cushions	<b>CM060-KITS</b>
L&XL Cushions	<b>CM060-KITL</b>

### Replacement Cushions

Size	Item#
Small	<b>CUCM060S</b>
Medium	<b>CUCM060M</b>
Large	<b>CUCM060L</b>
Extra Large	<b>CUCM060XL</b>

HCPCS#  
MASK - A7034  
HEADGEAR - A7035  
CUSHION - A7032



### Available Size Guide

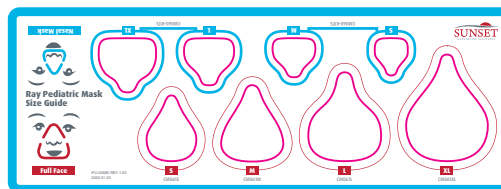

## Pediatric SleepWeaver® CPAP Mask

Item#  
**CM101325**  
Each

Loose fit provides ultimate comfort, a perfect seal, and eliminates strap marks

The launch of the SleepWeaver Advance Pediatric Soft Cloth PAP Mask marks the development of a revolutionary interface for Continuous Positive Airway Pressure (CPAP) used in pediatric patients. This new configuration extends the range of SleepWeaver Products to include pediatric users with delicate facial features. SleepWeaver Advance Pediatric is indicated for use on patients between 2-7 year old.

Like SleepWeaver’s other masks, the SleepWeaver Advance Pediatric incorporates the revolutionary Circadiance soft-cloth technology that quietly inflates like a balloon to create an airtight seal. The breathable, non-allergenic mask is comfortable—and it eliminates leaks, pressure points, sore spots, and pinching. SleepWeaver’s “loose fit” prevents strap marks, and the open-face headgear design accommodates eyeglasses and allows virtually unrestricted vision—great for people who like to fall asleep while reading or watching TV!



Same proven cloth technology enhanced to accommodate children 2 through 7 years of age

## Inflatable Air Cushion Breathing Mask with Valve - No Hooks

20/case

Size	Item#
Infant	<b>SBC01I</b>
Toddler	<b>SBC01T</b>

- Ergonomic cushion design provides an optimal seal with minimal pressure
- Clear mask permits easy patient observation
- Available in a variety of sizes for the best possible fit
- Inflation port for optimized seal



## Cough Assist Kit with Mask and 4ft Tube

Size	Item#	Comparable to OEM#
Infant	<b>CAKIT005I</b>	325-9237
Toddler	<b>CAKIT005T</b>	325-9236

### Includes

- 1 TUB04 4ft Tube
- 1 BF2200 Inline Bacterial Viral Filter
- 1 RES013 Connector
- 1 SBC01 Series Breathing Mask – sized at kit specifications



## Cough Assist Kit with Mask and 6ft Tube

Size	Item#	Comparable to OEM#
Infant	<b>CAKIT004I</b>	1090830
Toddler	<b>CAKIT004T</b>	1090831

### Includes

- 1 TUB06 6ft Tube
- 1 BF2200 Inline Bacterial Viral Filter
- 1 RES013 Connector
- 1 SBC01 Series Breathing Mask – sized at kit specifications



## Passive Circuit w/Exhalation Port and Bacterial/Viral Filter

Item#  
**VC1005P**

Includes 15mm tube  
with 22mm cuffs

Comparable to OEM#  
1147378, 1132340, 7615

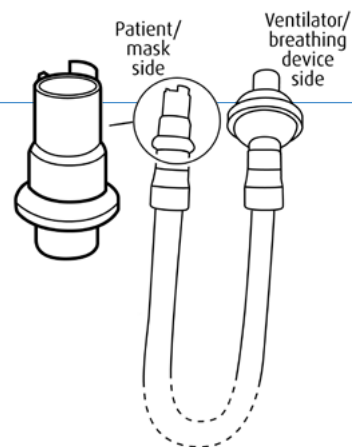

### Non-Heated Breathing Circuits

For use with Respironics Trilogy  
 22mm cuffs  
**30/case**

Item#	OEM#	Mode	Water Trap	Tube Diameter
<b>VC1001P</b>	1073220 & 1073229	Active	Yes	15mm
<b>VC1004P</b>	1073224 & 1073233	Passive	Yes	15mm

Item#  
**VC1001P**  
 Active  
 OEM#  
 1073220  
 1073229

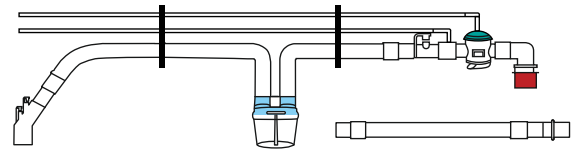
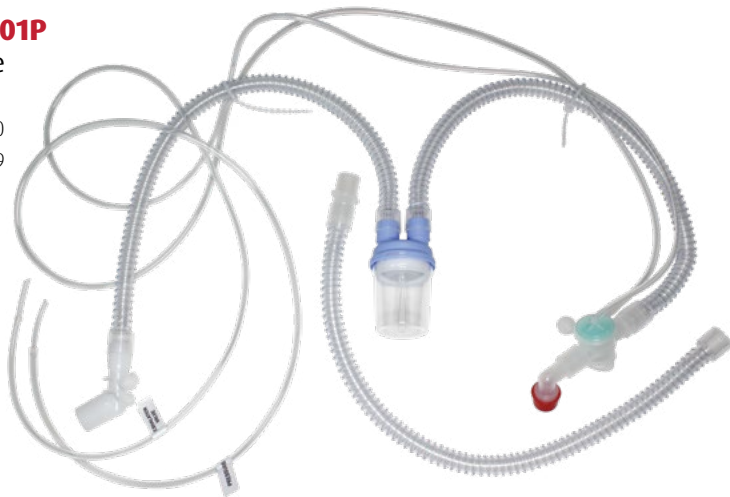

Item#  
**VC1004P**  
 Passive  
 OEM#  
 1073224  
 1073233

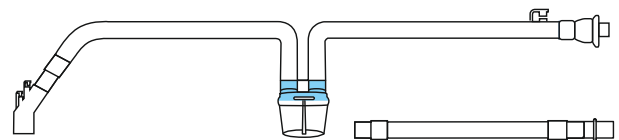

To use active circuits with Respironics Trilogy, simply cut ends off pressure and exhalation lines.

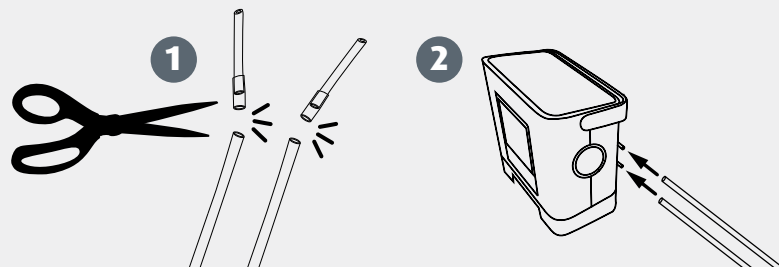

## Sunny the Bear Compressor Nebulizer

### Item#

#### NEB300BEAR

- Disposable Pediatric Mask (RES2210)
- Disposable T-Piece Kit (RES091)
- Foam Filters (BF018 x5)

#### NEB300BEAR-R

- Disposable Pediatric Mask (RES2210)
- Disposable T-Piece Kit (RES091)
- Reusable T-Piece Kit (RES093)
- Foam Filters (BF018 x5)

Sunny is the pediatric nebulizer designed to make treatment fun for kids! Sunny has rapid treatment times and a fun bear shape kids love. It also features Sunset's signature great value and eye-catching retail packaging. Sunny includes both a pediatric mask and a t-piece kit with medicine cup, t-piece, mouthpiece, corrugated reservoir tube, and 7-foot supply tube. Sunny includes replacement filters.



Comes in an attractive retail box that appeals to kids

- Rust-resistant
- Quiet (below 60dBA)
- 6ml medication capacity
- Average nebulization rate above 0.2ml/min
- Particle size: respirable fraction 0.5 to 5um 0.5um 80%
- Compressor pressure range 30-45 PSI
- Operation pressure range 12-14 PSI
- Liter flow range 8-10 LPM



## Handheld Mesh Nebulizer

Item#  
**NEB402**

**With internal rechargeable battery**

**Included**  
Medication cup  
USB cord  
Mask  
Mouthpiece  
Portable bag  
Manual



**Particle Size** MMAD < 5µm  
**Nebulization Rate** 0.25ml/min-0.9ml/min  
**Medication Cup Capacity** 10ml (Max)  
**Device Weight** Approx. 1/4 lb  
**Device Size** Approx. 1 1/2 x 2 x 3 7/8 inches

- Includes internal rechargeable battery that provides up to 1 hour of continuous use after full charge
- Great value pricing and quality
- Easy to operate and transport

## Disposable Nebulizer Kit

Item#  
**RES092**  
**50/case**

- Pediatric aerosol mask
- 6cc jet nebulizer bottle
- 7ft supply tube



## Aerosol Mask

Item#  
**RES2210**  
**50/case**

- Clear, soft vinyl for patient comfort
- Adjustable nose clip for secure seal
- Connector accepts 22mm aerosol tubing
- Individually packaged



## SperaChamber

Anti-Static Valved Inhaler Chamber for Metered Dose Inhaler



Item#  
**RES195-10**  
**10/case**

**RES195-50**  
**50/case**

- Inhalation valve
- Universal adapter
- Spiral vents
- Seal with exhalation safety valve
- Latex-free and DEHP-free



SperaChamber with Mask  
**10/case**

Item #	Size
<b>RES195MS</b>	Small (Infant)
<b>RES195MM</b>	Medium (Pediatric)
<b>RES195ML</b>	Large (Adult)

## Mini Oxygen Regulator CGA 870 Style

Item# **RES046**

Pediatric • Barbed

0-4 LPM • Each

0,  $1/32$ ,  $1/16$ ,  $1/8$ ,  $1/4$ ,  $1/2$ ,  $3/4$ , 1, 1 1/2, 2, 3, 4 LPM

HCPCS# E1353

For use with E size or smaller cylinders:

A, B, C, D, JD, E, M2, M4, M6, ML6, M7,  
M9, M15, M22, or M24.

Barbed hose outlet  
for easy connection to  
the oxygen tubing



"T" Handle for easy  
mounting — no tools  
needed

### Both Regulators Feature:

- Pressure gauge reads to 3000 PSI
- Easy-click flow selector knob
- 2-year warranty

## Mini Oxygen Regulator CGA 540 Style

Item# **RES047**

Pediatric • DISS

0-4 LPM • Each

0,  $1/32$ ,  $1/16$ ,  $1/8$ ,  $1/4$ ,  $1/2$ ,  $3/4$ , 1, 1 1/2, 2, 3, 4 LPM

HCPCS# E1353

For use with M60 and larger cylinders:  
M60, M90, M, MM, M122, M250, H, J, T or  
other cylinders with CGA 540 style valve.

Threaded  
DISS outlet



## Microflow Microdial Flowmeter



DISS Inlet • Barbed Outlet

Item#	Inlet Pressure	Inlet Pressure Range	Flow Range*
<b>RES8160048</b>			<b>A</b>
<b>RES8160050</b>	400 kPa (58 psi)	350 - 550 kPa	<b>E</b>



DISS Inlet • DISS Outlet

Item#	Inlet Pressure	Inlet Pressure Range	Flow Range*
<b>RES8160049</b>	400 kPa (58 psi)	345 - 500 kPa	<b>A</b>
<b>RES8160051</b>	350 kPa (51 psi)	250 - 450 kPa	<b>E</b>

\*Volumetric flow rates in standard liters per minute

Dial Position	Off	1	2	3	4	5	6	7	8	9	10	11
<b>Range A</b>	0	0.02	0.03	0.05	0.08	0.12	0.2	0.3	0.5	0.75	1	3
<b>Range E</b>	0	0.01	0.02	0.03	0.04	0.05	0.06	0.07	0.08	0.09	0.1	1

## Assured, repeatable accuracy to enable safe, effective weaning.

### What is Microflow used for?

Microflow is primarily used to supply supplementary oxygen to infants with bronchopulmonary dysplasia (BPD).

BPD is common in very low birth weight and pre-term infants that have needed mechanical ventilation or have been treated with high oxygen concentrations due to respiratory distress syndrome (RDS)/chronic lung disease (CLD).

The risk of RDS/CLD is inversely related to birth weight and gestational age.

Infants may need very low supplementary oxygen for many months to compensate for underdeveloped lungs.

### Microflow benefits

- Enables baby to receive oxygen therapy at home, putting families together sooner and increasing parent satisfaction
- Less time in hospital, lower cost of care
- Accurate, repeatable steps
- Micro step changes in flow
- Enables low flow rates to achieve target saturation
- Enables oxygen flow to be weaned



## Cannula with Tubing

Item#  
**RES1207V**  
Cannula with 7ft  
Supply Tube  
**50/case**

HCPCS# A4615



- Clean, fresh look
- 1-6 LPM
- Curved nasal prongs for added comfort
- 6-channel safety tubing designed to prevent kinks
- Soft, lightweight material is memory free for long-term comfort

## Simple O2 Mask

Item#  
**RES2200V**  
**50/case**

HCPCS# A4620



- 5-12 LPM
- Medium concentration
- Clear, soft vinyl for patient comfort
- Adjustable nose clip for secure seal

## Partial Rebreather / Non-Rebreather O2 Mask with 7ft Tubing

Oxygen High Concentration Mask with 7ft Safety Tubing and Reservoir Bag

Item#  
**RES2201V**  
50/case

OEM# 8120-7-50  
HCPCS# A4620



- 5-15 LPM
- Safety vent
- Clear, soft vinyl for patient comfort
- Adjustable nose clip for secure seal

## Non-Rebreather O2 Mask

With 7ft Safety Tubing & Reservoir Bag

Item#  
**RES2202V**  
50/case

HCPCS# A4620



- 10+ LPM
- Low-resistance check valves prevent rebreathing and allow exhaled gas to escape

## Trach Ties

**20/case**

### One-piece

• Easy on

Item#  
**RES029P-11** 2.5x30cm (11.5in)

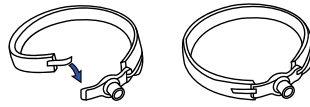

- Designed to provide secure stabilization of the tracheostomy tube
- Made from soft 60% Polyester, 20% Cotton, 20% Nylon

### Two-piece

• Easy off

Item#  
**RES030P-10** 2x25.5cm (10in)  
**RES030P-14** 2x35.5cm (14in)

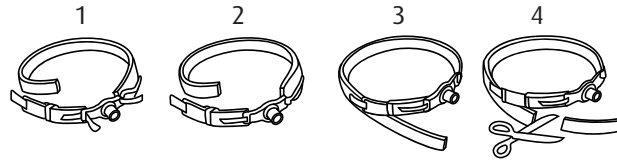

## Heat Moisture Exchanger

**30/case**

Item#  
**RES027NE-10**  
Inline HME — Neonatal



<b>TV Range (mL)</b>	15-50
<b>Moisture Output (mg H<sub>2</sub>O/L)</b>	30
<b>Weight (g)</b>	4.5
<b>Resistance (cm H<sub>2</sub>O)</b>	0.5 @ 10 LPM
<b>Dead Space (mL)</b>	2.5
<b>Connection (mm)</b>	15M,15F

## Tracheostomy Mask with O<sub>2</sub> Connector

**50/case**

Item#  
**RES2230**



- Latex-free
- 360° swivel in 2 places allows access from either side of the patient
- Comes with removable adapter to fit with aerosol or O<sub>2</sub> supply tubing

## Peak Flow Meter

Item# **RES052**  
10/case

50-800 L/min

- High performance
- Quality controlled
- Color areas indicator
- Slip design
- One-way valve
- Latex-free
- Phthalate-free



Item# **RES052MPD**  
Mouthpiece  
for Peak Flow Meter  
10/case

## Motif BiliTouch™ Phototherapy Blanket

Item#  
**MAT2300EAB**

Motif BiliTouch™ Phototherapy Blanket  
with Hard Case  
Each

**MAT2300EAB-W**

Motif BiliTouch™ Phototherapy Blanket with  
Hard Case and 2-Year Extended Warranty  
Each

**Motif BiliTouch™ Disposable Covers**

**MAT2300EAB-DC**

25/case

**Motif Phototherapy Eye Shield**

25/box

Size	Item#
Small	<b>MAT2300ES-S</b>
Large	<b>MAT2300ES-L</b>

The Motif BiliTouch™ phototherapy blanket is a biliblanket designed by healthcare professionals to treat newborn infants diagnosed with jaundice (hyperbilirubinemia). This portable, convenient phototherapy treatment device allows your patients to continue to hold, feed, and care for their baby while reducing high bilirubin levels at home.



- Convenient, ultra-portable phototherapy treatment with battery-powered option
- Patient-centered, lightweight design facilitates bonding with newborn infant
- LED light source, no fiber optic cables for easy positioning

# Standard Switch

## Sterile and latex-free

### Neonatal/Pediatric

#### With Y-Adapter

Item#	Description	Y-Adapter Size
VEN66000500	305mm, 5Fr	2-2.5mm
VEN66000600	305mm, 6Fr	2.5-3.5mm
VEN66000700	305mm, 7Fr	3-4mm
VEN66000800	305mm, 8Fr	3.5-4.5mm
VEN66001000	405mm, 10Fr	4.5-5.5mm
VEN66000500M	305mm, 5Fr, MDI Port	2-2.5mm
VEN66000600M	305mm, 6Fr, MDI Port	2.5-3.5mm
VEN66000700M	305mm, 7Fr, MDI Port	3-4mm
VEN66000800M	305mm, 8Fr, MDI Port	3.5-4.5mm
VEN66001000M	405mm, 10Fr, MDI Port	4.5-5.5mm

ISO color coded for instant recognition of catheter sizes.



Smooth tubing surface and atraumatic rounded catheter tip for minimal tracheal wall injury.



Once the airway is clear, withdraw the catheter completely into the plastic sheath. A black mark on the catheter indicates full withdrawal.



# Deluxe Switch (One-handed operation)

## Sterile and latex-free

### Neonatal/Pediatric

Item#	Description
VEN26000500	305mm, 5Fr
VEN26000500M	305mm, 5Fr, MDI Port
VEN26000600	305mm, 6Fr
VEN26000600M	305mm, 6Fr, MDI Port
VEN26000700	305mm, 7Fr
VEN26000700M	305mm, 7Fr, MDI Port
VEN26000800	305mm, 8Fr
VEN26000800M	305mm, 8Fr, MDI Port
VEN26001000	405mm, 10Fr
VEN26001000M	405mm, 10Fr, MDI Port

### Suction Control Switch

Ergonomic suction control switch with a built-in security lock to visually determine if the device is in the OFF/ON position. Offers a quick and easy, single-handed operation design, which allows you to keep your eye on the patient and do no harm. One-handed operation allows the free hand to support the ET or Trach device to ensure less trauma to the site.

### MDI Port

Provides access for drug delivery as needed. Large and easy to grip port allows for rapid medication introduction.

### Irrigation Port

Offers a one-way valve to prevent backflow leakage and easy access for cleaning the closed suction system.

### Black Ring Indicator

Ensures that the catheter is properly withdrawn from the ET or Trach device. Black ring must be visible in the plastic sheath after suctioning the patient.

### Catheter Tip

Atraumatic rounded catheter tip for minimal tracheal wall injury.



# Your sales representatives

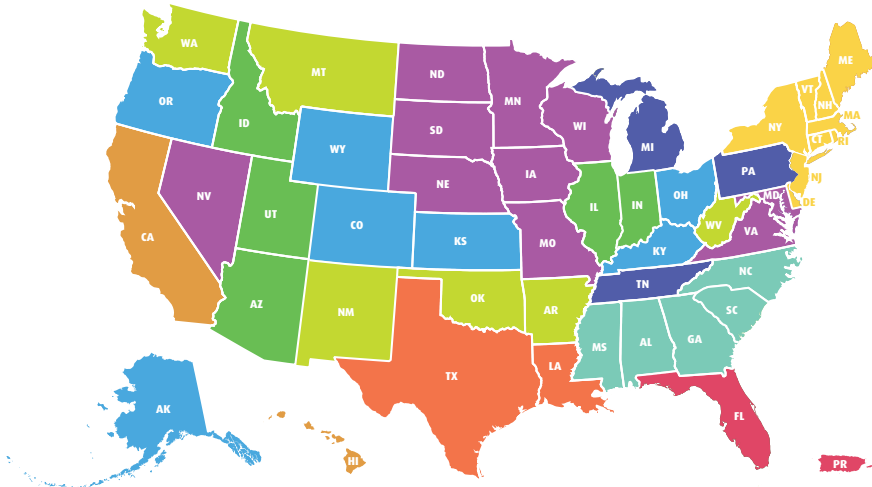

**Sean O'Donnell**

Direct 312-637-6558  
Ext 558  
Email sodonnell@sunsethcs.com



**Brian Lipson**

Direct 312-533-2463  
Ext 217  
Email blipson@sunsethcs.com



**Madison Gwilliam**

Direct 312-533-2459  
Ext 224  
Email mgwilliam@sunsethcs.com



**Jonny Deutsch**

Direct 872-259-3691  
Ext 691  
Email jdeutsch@sunsethcs.com



**Sam Powers**

Direct 872-258-1651  
Ext 876  
Email spowers@sunsethcs.com



**Michelle Chojnacki**

Direct 312-533-2486  
Ext 234  
Email mchojnacki@sunsethcs.com



**John Bisceglie**

Direct 312-533-2462  
Ext 205  
Email jbisceglie@sunsethcs.com



**Chris Crawford**

Direct 872-258-1650  
Ext 210  
Email ccrawford@sunsethcs.com



**Jon Kmiec**

Direct 312-533-2482  
Ext 234  
Email jkmiec@sunsethcs.com



**Ryan Eardley**

Direct 872-282-0751  
Ext 903  
Email reardley@sunsethcs.com



**Phil Cosens**

Direct 312-533-2470  
Ext 219  
Email pcosens@sunsethcs.com



**Danielle Dubowski**

Direct 312-533-2479  
Ext 231  
Email ddubowski@sunsethcs.com

## National Accounts



**Nikki Drake**

Direct 312-533-2469  
Ext 218  
Email ndrake@sunsethcs.com



**Gabrielle Barruzza**

Direct 312-638-8680  
Ext 680  
Email gbarruzza@sunsethcs.com



Phone 877-578-6738  
Fax 312-997-9985  
Email sales@sunsethcs.com  
Visit www.sunsethcs.com

Corporate Headquarters  
141 W Jackson Blvd Ste 1950  
Chicago IL 60604

Central Distribution Center  
2725 Alft Ln  
Elgin, IL 60124

Western Distribution Center  
6750 W Van Buren St Ste 100  
Phoenix, AZ 85043