





SMARTcheck ✓

OXYGEN + FLOW + PRESSURE

Quick Start Guide

Basic Operation



To Use the Smart Check:

1. Power on 
2. Remove humidifier 
3. Connect to concentrator 
4. Choose pulse or continuous 
5. % O₂ and Flow are displayed
6. Cover outlet to read pressure 



For checking oxygen concentrators only.
Pour vérifier la sortie d'oxygène d'un
concentrateur seulement.

For Calibration Check:

1. Deliver 2 to 4 LPM of Pure O₂
100% O₂  (not a concentrator)
2. Hold  button
3. 98.5-101.5% = OK

Smart Check Overview

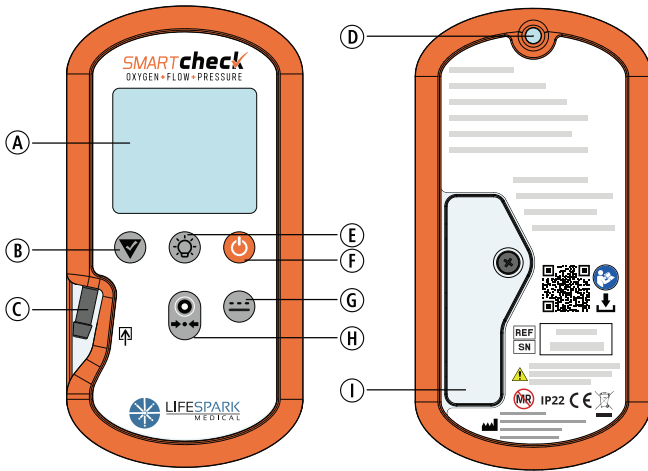

- A LCD Display
- B Calibration Check Button
- C Sample Inlet
- D Flashlight
- E Flashlight/Backlight Button

- F Power On/Off
- G Mode Button
- H Sample Outlet
- I Battery Cover

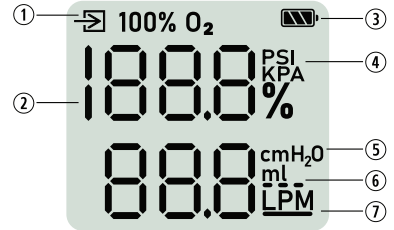

- ① Feed 100% O₂ Indicator
- ② O₂ Percent Display (%)
- ③ Battery Indicator
- ④ Pressure Unit (PSI or KPA)
- ⑤ Displaying Low Range Pressure (cmH₂O)
- ⑥ Displaying Pulse Volume (ml)
- ⑦ Displaying Continuous Flow Rate (LPM)

For More Information see User Manual Section 1

Additional Details

Continuous Mode

This default mode is used to test continuous oxygen concentrators and pulse concentrators in continuous mode.

1. Verify oxygen concentrator is in Continuous Mode.
2. Verify Smart Check is displaying **LPM** for Continuous Mode testing. If not, press **---**.
3. Allow reading to stabilize for 10 seconds.
4. Read the O₂% and flow rate (LPM).

Pulse Mode

This mode is used to test pulse oxygen concentrators in pulse mode.

1. Verify gas concentrator is in Pulse Mode and pulsing.
2. Verify Smart Check is displaying **ml** for Pulse Mode testing. If not, press **---**.
3. Wait 12 pulse cycles for values to stabilize and display.
4. Read the O₂% and flow rate (ml).

Changing Pressure Units

1. With the unit off, press and hold **⏻**.
2. While holding **⏻**, press and release **⏴**.
3. Release **⏻**.
4. New pressure unit will flash (**KPA** or **PSI**) for 4 seconds before resuming normal operation.

Measuring Pressure

1. From either continuous or pulse mode testing, cover outlet with finger.
2. Wait for pressure to be displayed.

The Smart Check can also be used to test pressures on nebulizers, CPAPs and other devices.

Pressures < 75 cmH₂O (~1 psi) will also be shown in cmH₂O.

Backlight

With the device **ON**, press .
Backlight remains on for 30 seconds.

Flashlight

With the device **OFF** press .
Flashlight remains on for 60 seconds.

Auto Off

Device will turn off after 2 minutes of inactivity.

Error Codes

Smart Check will display error codes under certain conditions. See User Manual Section 4 for error details.

E88

Errors appear as E followed by 2 digits (as shown).

Learn More - User Manual

Download the User Manual



Front & Back.....	Section 1.1.1
Display.....	Section 1.1.2
Controls.....	Section 1.1.3
Operating Instruction.....	Section 2
Factors affecting accuracy.....	Section 3
Error Codes.....	Section 4
Cleaning & Maintenance.....	Section 5
Troubleshooting.....	Section 6
Replacement Parts.....	Section 8

www.SmartCheckO2.com

Part No. MA0238EN, Rev C