

# Smart Check

## The Ultimate Oxygen + Flow + Pressure Analyzer

Item#  
**RES7003**

### Smart Check Analyzes:

#### Continuous Concentrators

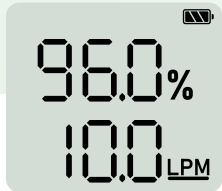

Measure Oxygen & Flow Rate

#### Pulse Mode Concentrators

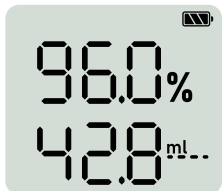

Measure Oxygen & Pulse Volume

#### Pressure



Measure Pressure: Concentrators, CPAP, BiPAP & Nebulizers

*Portable, handheld* oxygen analyzer designed specifically for *testing* and *maintaining* oxygen concentrators



	SMART <b>check</b>	UltraMax O2	Pro2 Check Elite
Measure Oxygen & Flow	✓	✓	✓
Test Pressure	✓	✓	✓
Quick Touch Pressure Check	✓	✓	✗
Calibrated for Life	✓	✓	✗
Test Pulse Concentrators	✓	✗	✗
Test CPAP + Nebulizer	✓	✗	✗
Flashlight	✓	✗	✗
Backlight	✓	✗	✗
Tube Management	✓	✗	✗
Fast Environmental Response	✓	✗	✗
Cost	\$	\$\$\$	\$\$

New! One-point calibration now available.

# Smart Check

The Ultimate Oxygen + Flow + Pressure Analyzer

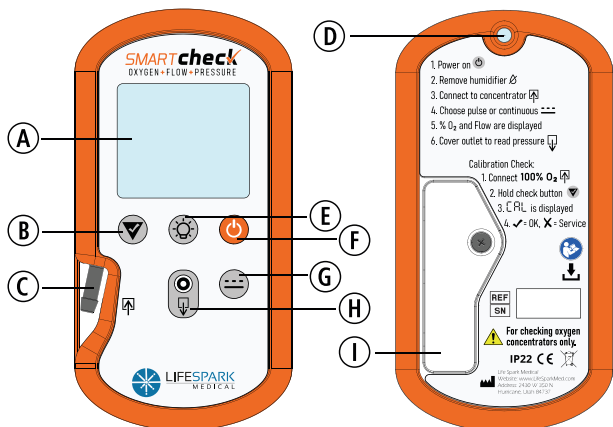

- A LED Display
- B Calibration Check Button
- C Sample Inlet
- D Flashlight
- E Flashlight On/Off Button
- F Power On/Off Button
- G Mode Button
- H Sample Outlet
- I Battery Cover

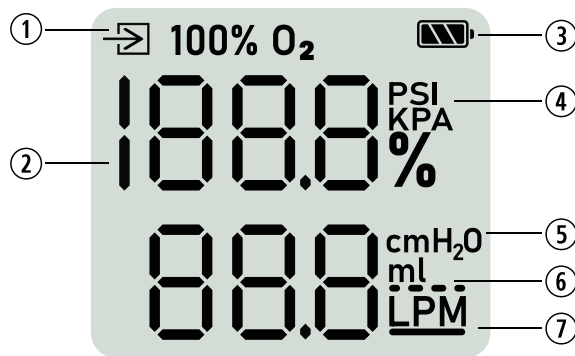

- 1 Feed 100% O<sub>2</sub> Indicator
- 2 O<sub>2</sub> Percent Display (%)
- 3 Battery Indicator
- 4 Pressure Unit (PSI or KPA)
- 5 Displaying Low Range Pressure (cmH<sub>2</sub>O)
- 6 Displaying Pulse Volume (ml)
- 7 Displaying Continuous Flow Rate (LPM)

## TECHNICAL specifications

Dimensions.....75 x 147 x 27 mm (2.95 x 5.79 x 1.06 in)  
 Weight.....0.23 kg (0.5 lbs.)  
 Battery Life.....1 year typical use (>16k read cycles)\*  
 Battery Type.....2 replaceable AA batteries  
 Operating Temperature.....5° - 40°C (59° - 104°F)  
 Storage Temperature.....-25° - 70°C (5° - 140°F)  
 Auto Shutoff.....2 minutes  
 Atmospheric Pressure.....700 - 1060 hPa absolute\*\*  
 Humidity.....0 - 90% (non-condensing)  
 Pressure Units.....PSI, kPa, cmH<sub>2</sub>O  
 Sample Rate.....Continuous Mode: 1 Hz  
 .....Pulse Mode: 19.2 Hz  
 Response Time.....10 seconds  
 Start-up Time.....2.5 seconds

\*Read cycle estimate is without backlight use. 1 year estimate includes occasional use of the backlight/flashlight. The backlight and flashlight consume power 10x faster than the analyzer alone. Using the backlight constantly will significantly reduce battery life.  
 \*\*The Smart Check automatically compensates for changes in barometric pressure to maintain accuracy.

### Specifications Concentration Mode

Range (concentrator).....20.9 - 96%  
 Range (pure O<sub>2</sub>).....20.9 - 100%  
 Accuracy.....±1.5% full scale  
 Resolution.....0.10%

### Specifications Flow Mode

Range.....0 - 10 LPM volumetric  
 Resolution.....0.1 LPM  
 Accuracy.....±0.2 LPM

### Specifications Pulse Mode

Range.....3 - 200 ml  
 Resolution.....0.1 up to 100 ml, 1 above 100 ml  
 Accuracy.....±3 ml

### Specifications Pressure Mode

Range.....High: 0 - 40 PSI (0 - 275 kPa)  
 .....Low: 3 - 70 cmH<sub>2</sub>O  
 Resolution.....PSI and cmH<sub>2</sub>O: 0.1  
 .....kPa: 0.1 up to 200, 1 above 200  
 Accuracy.....High: ±0.5% of reading  
 .....Low: ±0.3 cmH<sub>2</sub>O

To order or request information

P 312.997.9980 E sales@sunsethcs.com W SUNSETHCS.COM

